

goot® DESOLDERING STATION TP-200AS/280AS



OPERATION MANUAL

Thank you for buying the **goot** Desoldering Station. Read this Owner's Operation Manual before using your desoldering station.

NOTE This is a common operation manual for TP-200AS & TP-280AS. Each model number is mentioned in the text. Be sure to read properly for your model.

1. SAFETY MARK DEFINITIONS
2. FOR SAFE OPERATION
3. SPECIFICATIONS
4. PACKAGE CONTENTS / NAME OF PARTS
5. SETTING
6. OPERATION
7. MAINTENANCE
8. REPLACEMENT PARTS

TAIYO ELECTRIC IND.CO.,LTD.

www.goot.co.jp E-mail: info@goot.co.jp

KEEP THIS MANUAL FOR FUTURE REFERENCE

5-3. Connect the desoldering gun to the control box.

ex.) TP-200AS

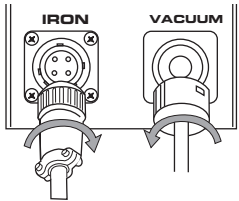

5-4. Put the desoldering gun into the soldering iron stand.

5-5. Check that the power switch on the control box is OFF (○ side) and then plug in the control box.

WARNING Ensure that the unit is properly grounded to avoid electrical shock. The desoldering gun is conductive.

5-6. Set the desired temperature by the temperature setting knob.

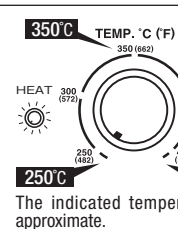

5-7. Turn the power switch ON (to I side). The [HEAT] lamp will light up and the heater will start heating up. When the [HEAT] lamp flashes the desoldering station is ready to use. (approx. 2-3 mins)

NOTE Some smoke will be produced during initial operation, but it will soon stop. No smoke produced after the initial operation.

WARNING Never touch the nozzle or other metal or plastic part. These areas get very hot. Possibly resulting in serious personal injury or damage. Be sure that the nozzle has sufficiently cooled down when storing.

WARNING To prevent fire or personal injury, turn off and unplug the desoldering station if there is a burning smell, overheating, or if the plastic parts deform. Do not use it again and contact your nearest distributor.

6. OPERATION

TP-200AS

Place the nozzle over the leads of the component to be removed. Wait until the solder melts, then pull the trigger for desoldering.

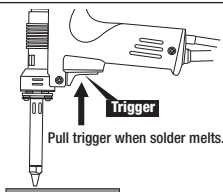

TP-280AS

Place the nozzle over the leads of the component to be removed. Wait until the solder melts, then pull the trigger slightly. The pump starts operating, and the vacuum is created in the vacuum chamber. Next, pull the trigger more. The open-valve will open, and the solder is pumped.

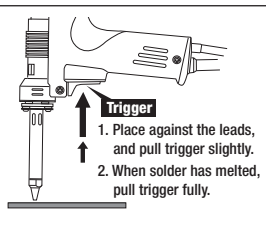

1. SAFETY MARK DEFINITIONS

In this manual, the following safety marks are used.

WARNING
Failure to obey a safety warning could result in serious injury or death to yourself or to others, or in physical damage.

CAUTION
Failure to obey a safety warning could result in injury to yourself or to others, or in physical damage.

NOTE A note or word of advice.

2. FOR SAFE OPERATION

1. Do not use in dangerous environments. Never use it in damp, humid or wet locations (including outside), or near flammable substances.
2. Keep children and bystanders away from the unit.
3. Turn off the power when not in use.
4. Your desoldering station is an electrical tool used to remove solder in order to free components from printed circuit boards. Do not use this for any other purpose.
5. Wear proper apparel and safety glasses.
6. Connect to a correct AC power supply. Do not use with any power voltage other than the indicated voltage.
7. If the desoldering unit cord or the power cord, is damaged, stop using immediately and turn off the power. Return to the distributor for replacement.
8. Be sure to use the ST-76 soldering iron stand included with this desoldering station. Other soldering iron stands may melt the parts of this unit.
9. Make sure that the machine must be grounded at all times to prevent electrical shocks and static electricity.

3. SPECIFICATIONS

MODEL	TP-200AS	TP-280AS
Voltage	110V, 120-130V, 220-240V AC 50/60Hz	
Power Consumption	130W(110V, 120-130V), 170-200W(220-240V)	
Temperature Setting Range	250-450°C (482-842°F)	
Heater	Ceramic heater with internal sensor	
Temperature Control System	Sensor feedback (ON-OFF control)	
Insulation Resistance	Over 100MΩ	
Vacuum Pump System	Diaphragm system	
Ultimate Pressure	-0.08MPa (-600mmHg)	
Dimensions	Control Box	95(W)x256(L)x205(H)mm
	Desoldering Gun	220x155mm
Weight	Control Box	Approx.2.6kg (w/o cord, hose)
	Desoldering Gun	250g (w/o cord)
Total	Approx.2.9kg	
Leak Voltage	Less than 2mV	
Ground/Earth Resistance	Less than 2Ω	
Connecting cord length	1.2m	
Power cord length	3-prong cord 1.5m	

Printed in Japan, MAY 2013 A4530MH01

NOTE TP-200AS After releasing the trigger, the pump will operate for approx. 0.5 seconds more, to pump the collected solder in the nozzle.

TP-280AS When the vacuum chamber is completely filled, the pump cannot take effect even if the trigger is pulled. In that case, pull the trigger in completely. The open-valve will open, and restore negative pressure in the chamber. Then the pump will operate again.

CAUTION Do not pull the trigger for more than 2 seconds. Wait at least 10 seconds between trigger pulls. Failure to do so could result in the heater or motor overheating.

After desoldering operation, remove any solder scraps on the nozzle by the wetted heat-resistant sponge on the soldering iron stand.

NOTE Clean the nozzle with the cleaning pin frequently during desoldering work. A cleaning drill is an optional part for some nozzle sizes.

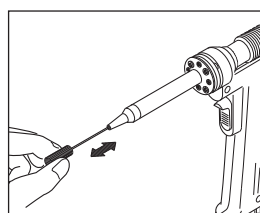

When operation is completed, push in and pull out the cleaning pin 3 or 4 times. Then pull the trigger once. This will extend the nozzle life. (Lastly, do not fail to put the pretinning on the nozzle tip.)

7. MAINTENANCE

WARNING Turn off the power switch (to ○ side), unplug the power cord before maintenance. And be sure that the nozzle is cooled down.

CAUTION Use only genuine goot replacement parts for maintenance. The use of any other parts may be hazardous and cause damage to the unit.

CLEANING AND REPLACEMENT OF CARTRIDGE, FILTER

1. Pull back the slider and take out the cartridge.
2. Remove the solder scraps from the cartridge.
3. Connect the arrow side of the cartridge to the front ring gasket. Return the slider to the front. Make sure that the rear plug goes into the cartridge.

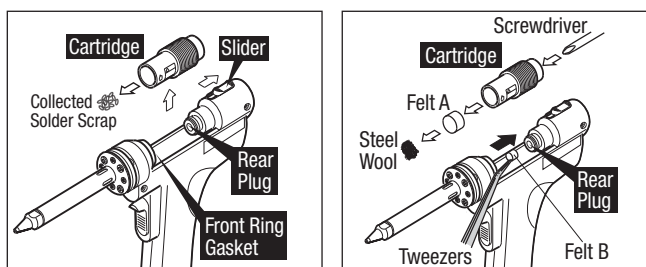
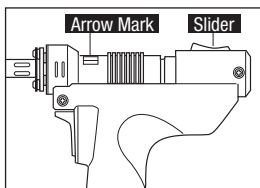

4. PACKAGE CONTENTS / NAMES OF PARTS

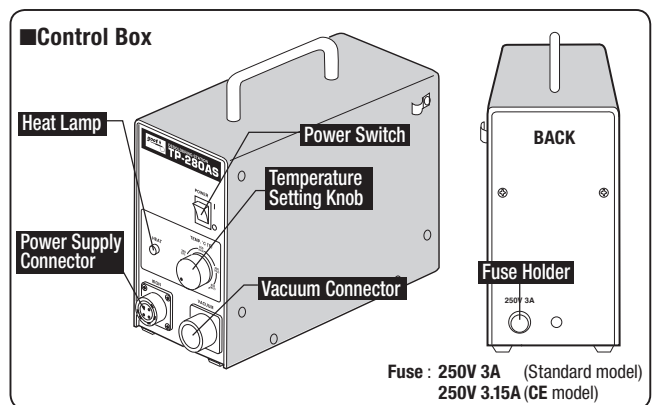

Fuse : 250V 3A (Standard model)
250V 3.15A (CE model)

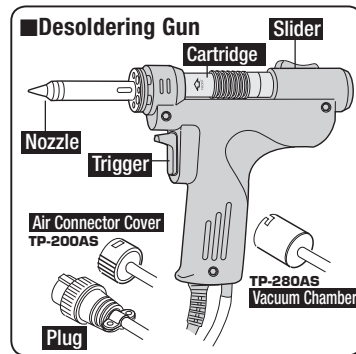

■ Soldering Iron Stand
■ Operation Manual

■ Filter Set TP-100F

Felt A Felt B Steel Wool

■ Cleaning Pin TP-100CP0.7

(TP-100CP1.3 in TP-280AS)

5. SETTING

CAUTION To prevent any damage that may occur during transport, screws have been affixed in 4 places. Ensure that all screws are removed before use. To reship, re-affix the screws in their original positions.

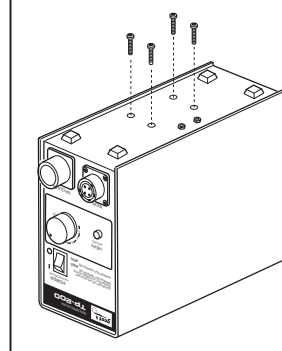

5-1. Assemble the soldering iron stand. Do not attach the holding flange to the front opening.

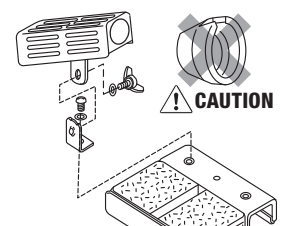

5-2. Place the cleaning pin into its holder provided at the rear right side of the control box.

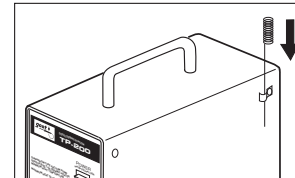

NOTE Do not use this desoldering gun without both felt A and felt B. The pump could be damaged. TP-280AS: The powerful suction makes many more filter clogs than TP-200AS. Requires frequent replacing of the filter to maintain desoldering power.

REPLACEMENT OF NOZZLE

When the clogged collected solder in the nozzle cannot be removed by the cleaning pin or cleaning drill, the nozzle needs to be replaced.

1. Turn the nozzle counterclockwise using a wrench (11mm) and remove it.
2. Replace with a new nozzle. Be careful not to overtighten it.

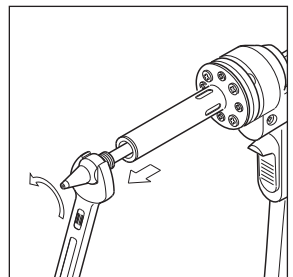

8. REPLACEMENT PARTS

NOZZLE

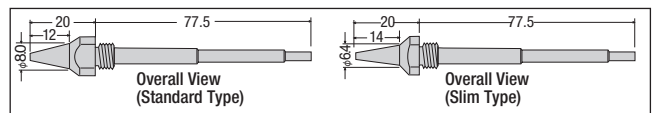

Part NO.	Gauge	Part NO.	Gauge
TP-100N-08	φ0.8mm	TP-100N-S8	φ0.8mm
TP-100N-10 (TP-200AS Standard)	φ1.0mm	TP-100N-S1	φ1.0mm
TP-100N-15	φ1.5mm	TP-100N-S5 (TP-280AS Standard)	φ1.5mm
TP-100N-25	φ2.5mm		

REPLACEMENT PARTS

- ☑ Heater TP-100H
- ☑ Heater Pipe TP-100HP
- ☑ Filter Set (3pcs) TP-100F
- ☑ Felt B (10pcs) TP-100RFT
- ☑ Cartridge Set TP-100K
- ☑ Steel Wool Only TP-100UL

Filter Set TP-100F

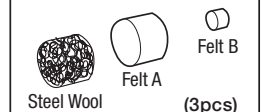

Cartridge Set TP-100K



WARNING Use this desoldering gun exclusively to prevent the injury or damage.

Cleaning Pin

- ☑ φ0.7mm (for φ0.8 & 1.0mm nozzle) TP-100CP 0.7
- ☑ φ1.3mm (for φ1.5 & 2.5mm nozzle) TP-100CP 1.3

Cleaning Pin Vice (Option)

- ☑ Pin vice body (The drill bit is not included) TP-100PV
- ☑ Drill Bit φ 0.7mm TP-100DB-07
- ☑ Drill Bit φ 0.9mm TP-100DB-09
- ☑ Drill Bit φ 1.4mm TP-100DB-14
- ☑ Drill Bit φ 2.4mm TP-100DB-24

Cleaning Pin